

# L10402B800R-10

**UNCONTROLLED DOCUMENT**

## PHYSICAL DIMENSIONS:

A	1.01 [0.040]	+	0.18 [0.007]
B	0.50 [0.020]	+	0.20 [0.008]
C	0.50 [0.020]	+	0.20 [0.008]
D	0.30 [0.012]	+	MAX.

Z vs. FREQUENCY  
IMPEDANCE UNDER DC BIAS

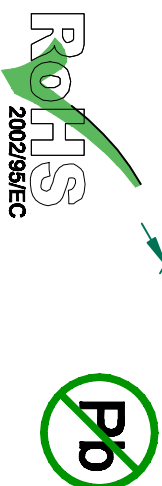
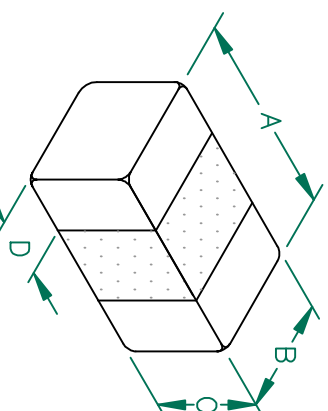
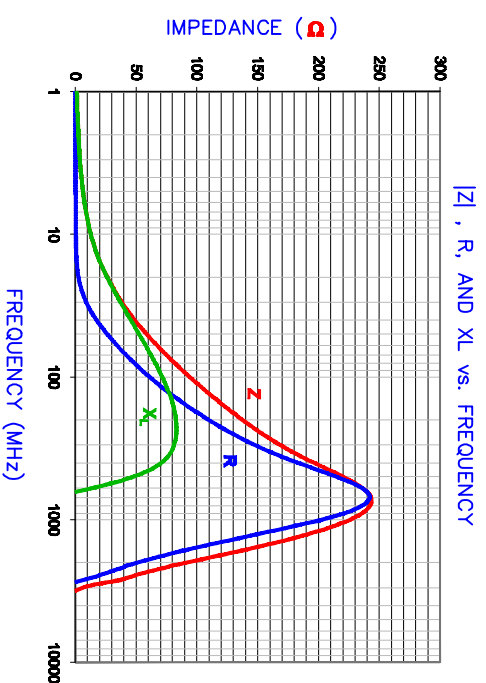
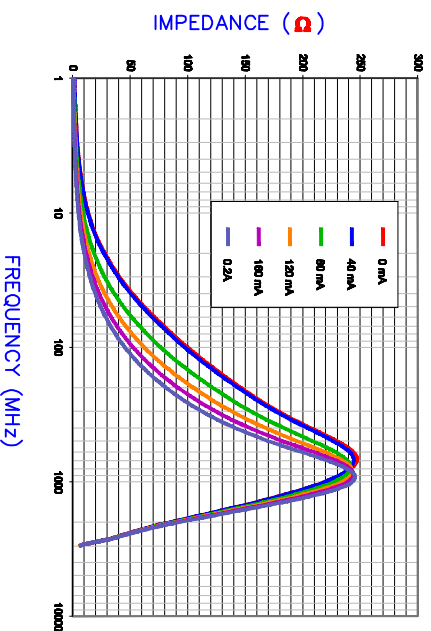

ELECTRICAL CHARACTERISTICS:		
Z @ 100MHZ (Ω)	DCR (Ω)	Rated Current
Nominal	80	
Minimum	60	
Maximum	100	0.80 200 mA

NOTES: UNLESS OTHERWISE SPECIFIED

1. TAPED AND REELED per CURRENT EIA SPECIFICATIONS 7" REELS, 10,000 PCS/REEL, PAPER TAPE.
2. TERMINATION FINISH IS 100% TIN.
3. COMPONENTS SHOULD BE ADEQUATELY PREHEATED BEFORE SOLDERING.

## LAND PATTERNS FOR REFLOW SOLDERING

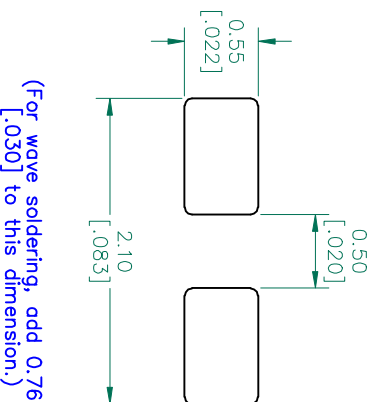

## RECOMMENDED SOLDERING CONDITIONS

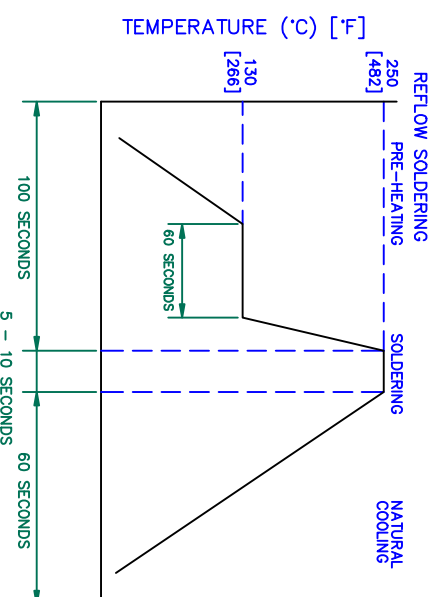

DIMENSIONS ARE IN mm [INCHES]

REV	DESCRIPTION	DATE	INT	CO #	PROJECT/PART NUMBER	REV	SCALE	PART TYPE	DRAWN BY:
C	CORRECT Z SPECS	09/11/08	JRK		L10402B800R-10	C	NTS	CO-FIRE	JRK
B	UPDATE COMPANY LOGO	07/08/08	JRK						
A	ORIGINAL DRAFT	05/10/06	JRK						

This print is the property of Laird Tech and is loaned in confidence subject to return upon request and with the understanding that no copies shall be made without the written consent of Laird Tech. All rights to design or invention are reserved.

